

# Insert Grinding Wheels

VR1802I



## GENENTECH CO., Ltd.

Every insert manufacturer is looking for how to improve productivity and quality in his production process.

To meet the expectations of our customers Genentech offers grinding wheels with exceptional properties and high quality.

All Genentech insert grinding wheels have been proven to be very successful through numerous customer-specific solutions.



- Shorter cycle time
- Longer wheel life
- High cutting edge quality



- Cost reduction per parts
- Increase of productivity
- High quality parts



## Product Portfolio

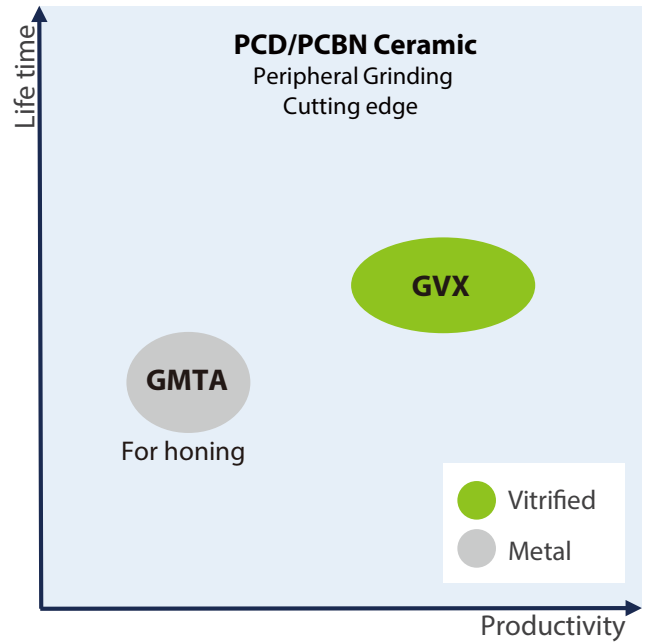
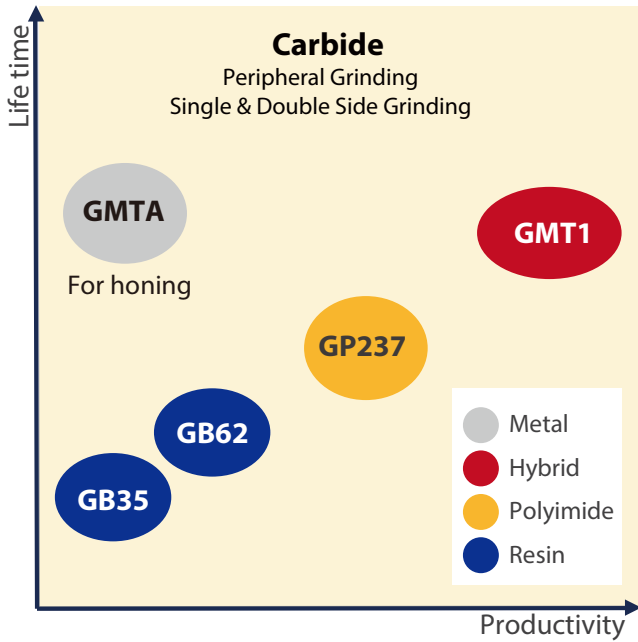

## Case Study

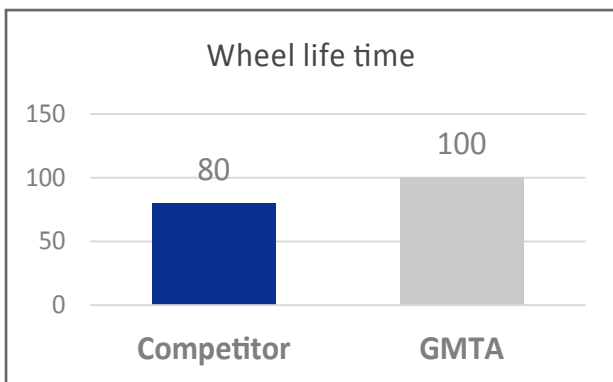
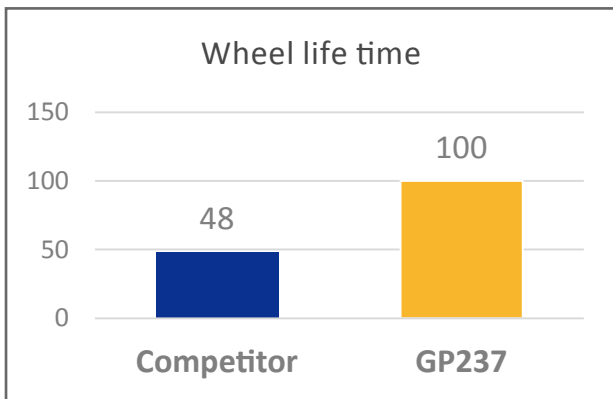

Grinding wheel spec : D40 C100 GP237  
12A2 400x12x6  
Machine : Agathon 400  
Work piece : Carbide Insert K20~30  
Wheel speed : 20 m/s

Grinding wheel spec : D10 C150 GMTA  
12A2 350x10x6  
Machine : Agathon combi 350  
Work piece : Carbide Insert for Aluminum alloys  
(High positive) K20~30  
Wheel speed : 20 m/s

## Peripheral Grinding for Carbide Insert

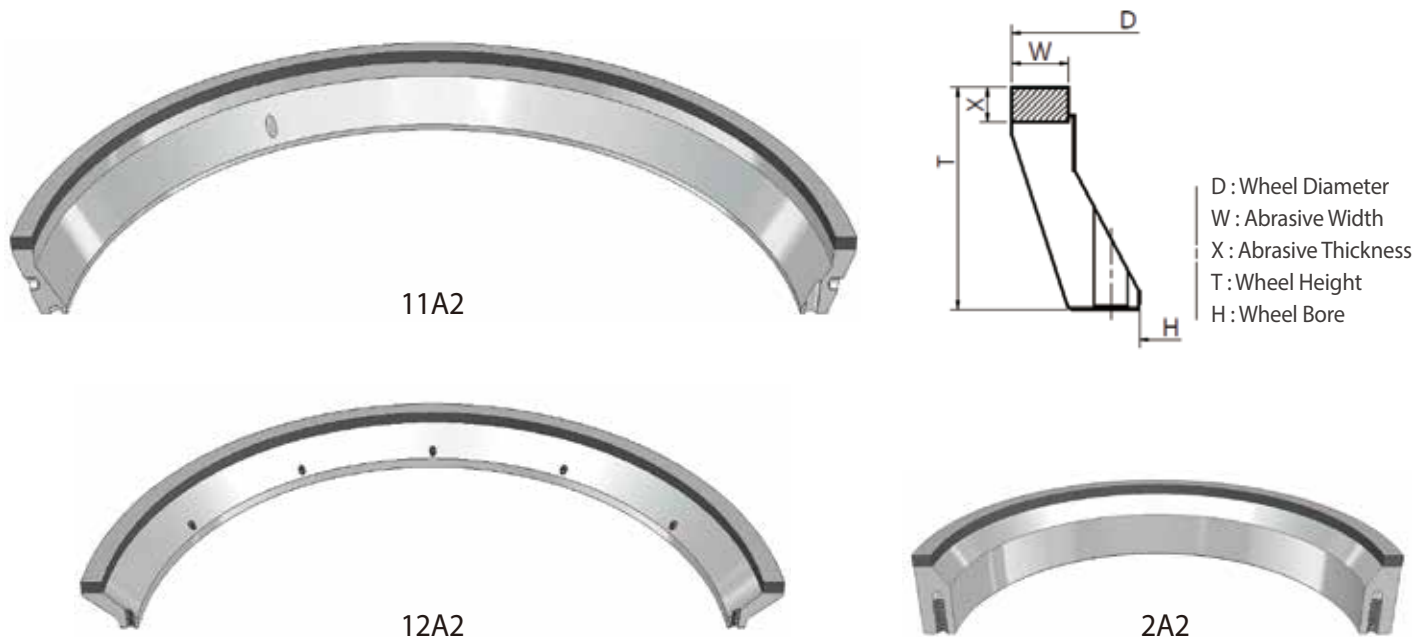

Shape	D	T	W	X	H	Grit Size	Bond	
11A2	400	Per request	8-12	6-10	Per request	D54 D46 D40	GP237	Polyimide
	350	Per request	8-12	6-10	Per request			
	250	Per request	8-12	6-10	Per request			
12A2	400	Per request	8-12	6-10	Per request	D64 - D40	GB62	Resin
	350	Per request	8-12	6-10	Per request			
	250	Per request	8-12	6-10	Per request			
2A2	400	Per request	8-12	6-10	Per request	D54 D46 D40	GMT1	Hybrid
	350	Per request	8-12	6-10	Per request			
	250	Per request	8-12	6-10	Per request			
	400	Per request	8-12	6-10	Per request	D20 - D7	GMTA	Metal
	350	Per request	8-12	6-10	Per request			
	250	Per request	8-12	6-10	Per request			

Recommended parameter      Grinding wheel speed      V 16~26 m/s  
 Dressing wheel speed      V 4~8 m/s  
 Dressing amount      0.02~0.04 mm

## PCD/PCBN Insert Cutting Edge Grinding

Shape	D	T	W	X	H	Grit Size	Bond	
11A2	400	Per request	8-12	6-10	Per request	D20 - D7	GVX	Vitrified
12A2	350	Per request	8-12	6-10	Per request			
2A2	250	Per request	8-12	6-10	Per request			

Recommended parameter      Grinding wheel speed      V 14~26 m/s  
 Dressing wheel speed      V 6~12 m/s  
 Dressing amount      0.02~0.05 mm

## PCD/PCBN Insert Cutting Edge Grinding

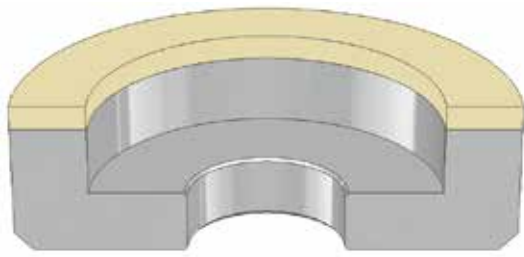

6A2

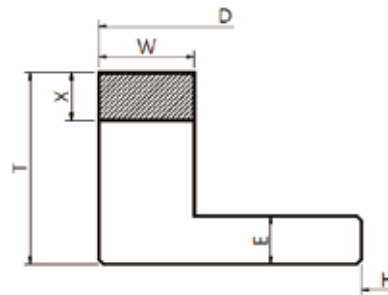

D : Wheel Diameter  
 W : Abrasive Width  
 X : Abrasive Thickness  
 T : Wheel Height  
 H : Wheel Bore

Shape	D	T	W	X	H	Grit Size	Bond	
6A2	150	Per request	6-20	6-20	Per request	D46 - D5	GVX	Vitrified
	150	Per request	6-20	6	Per request	D54 - D40	GB62	Resin
	150	Per request	6-20	6	Per request	D7 - D5	GMTA	Metal

Recommended parameter  
 Grinding wheel speed 14~26 m/s  
 Dressing wheel speed 6~12 m/s  
 Dressing amount 0.02~0.05 mm  
 Oscillation 40~120 passes / min

## Single & Double Side Grinding Wheel

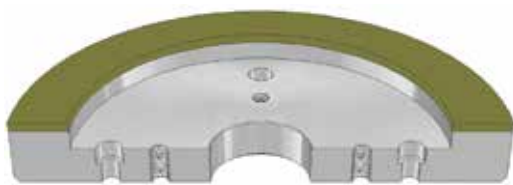

6A2M



2A2

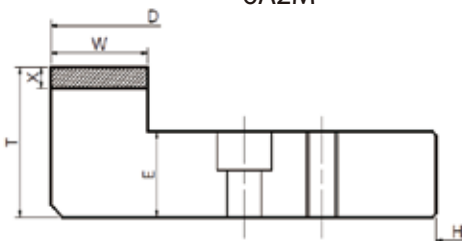

D : Wheel Diameter  
 W : Abrasive Width  
 X : Abrasive Thickness  
 T : Wheel Height  
 H : Wheel Bore

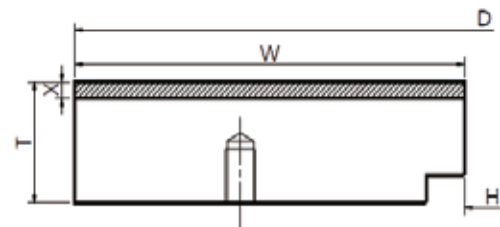

Shape	D	T	W	X	H	Grit Size	Bond	
6A2M	250-400	Per request	25-30	6	Per request	D64 - D40	GB62	Resin
	250	Per request	25-30		Per request		GMT1	Hybrid
2A2	300-455	Per request	50-155		Per request		GB35	Resin

Recommended parameter  
 Grinding wheel speed 16~26 m/s  
 Dressing wheel speed 8~12 m/s  
 Dressing amount 0.02~0.04 mm

# YOUR BEST SOLUTION FOR YOUR GRINDING PROCESS

To accomplish goals together with our customers, this is our entitlement. Our company is fairly young, founded in 2009, but through cooperation with our customers challenges are mastered fast and competent. Sustained success means to be fit for the future. We offer superior quality, high precision and short delivery times for our customers.

